

Quickstart

Hotfog Resonator A1-A2-A3

For more information please go through the entire user manual.

Step 1

Remove all protection packaging materials and. Turn the compressor on and check the pressure gauge. Set it to 7 or 8 bar using the pressure reducer.

Bring the pressure up or down by pulling up slightly on the knob from the reducer En turn it right to have more pressure en left to have lower pressing.



Compressor 7-8 bar

Step 2

Check the pressure gauge when the Hotfog RLVM. If necessary, attach it to the desired pressure.

This ranges from 6 to 6,5 bar pressure. The best drop is obtained at a pressure proportional to the flow rate. This is indicated on the manometer of the pressure reducer. Keep in mind to the droplet formation, called the splashing of the resonator.

Bring the pressure up or down by pulling up slightly on the knob from the reducer En turn it right to have more pressure en left to have lower pressing. first before pulling up slightly on the knob.



Hotfog RLVM 5 bar

Step 3

One nozzle gives about 3 liters per hour.

Always test the delivery from per hour with your particular liquid.



Step 4

Check the resonator, it should be centered like the drawing below.

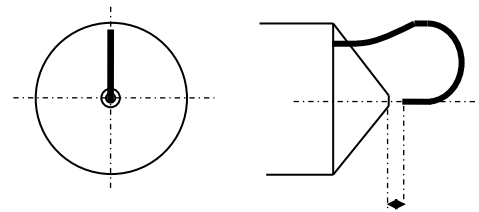

Centered, and distance about 1 mm

Step 5

Connect or put the tube into the storage.



Step 6

Plug the cord into a 220 volt outlet And press the Reset button on the left side of the box.



Step 7

Turn the timer on the desired time The fan is turn and warm-up begins. By pressing the flow pushbutton you are testing the fluid flow. The unit turns off after the expiration of the time set by itself.

